

Parameters

Electrical Parameters (from HDL-MPPI.48):	
Buspro power supply	DC12-30V
Buspro power consumption (from HDL-MPPI.48)	40mA/DC24V
Ultrasonic sensing range	6m (diameter)
Static and dynamic sensing range	6m (diameter)
Environmental Conditions:	
Working temperature	-5°C~45°C
Working relative humidity	Up to 90%
Storage temperature	-20°C~+60°C
Storage relative humidity	Up to 93%
Approved:	
CE	
RoHS	
Product Information:	
Dimensions	86×86×31(mm)
Weight	109(g)
Housing material	Glass , Fresnel lens, ABS
Installation	EU Wall Box
IP protection	IP20

Important Notes

- It must work in conjunction with HDL-MPPI.48 (be installed in wall-box)
- Installation Location – If use (PIR) indoor, keep it away from air outlet and heat source
- Environment temperature — If use (PIR), please keep the temperature below 36°C
- Detect target – PIR only can detect moving objects with heat radiation like human, animal, ultrasonic can detect all moving objects
- Buspro cable — HDL Buspro/KNX cable, 0.8mm single-core copper cable.
- Buspro Connection — Series connection (hand-in-hand)
- Installation — 86×86mm EU wall box

Installation Step

- Connect Buspro cables. Make sure the colors of wires comply with the definition.
- Make sure the Buspro cable is correct and has no short circuit.
- Mount the HDL-MPPI.48 in the wall-box
- Put this device into HDL-MPPI.48

Overview



HDL-MSPU05.48 Wall mount ultrasonic & PIR sensor. It includes Ultrasonic sensor, PIR sensor, temperature sensor, LUX sensor and one push button, it supports HDL security mode and command.

Functions

- Buspro enable with Temperature sensor, PIR sensor, LUX sensor one push Button, Ultrasonic sensor Universal switch, total in 8 input logic conditions per logic block
- With 24 logic blocks, each logic block have 8 input and 20 output commands
- Variety control includes scene switch, sequence switch, universal switch, signal channel adjust, audio , curtain, GPRS panel control, background music control, etc.
- With two logic relationships: OR, AND
- Adjustable infrared sensitivity, sensitivity range:1-100
- Adjustable ultrasonic sensitivity , sensitivity range:1-100
- Each logic block has two universal switch inputs, can totally set 48 universal switches.
- Supports upgrade from HDL Buspro

HDL Buspro Definition for Cable

HDL Buspro	HDL Buspro/KNX
DC24V	Red
COM	Black
DATA-	White
DATA+	Yellow

Dimensions and Wiring

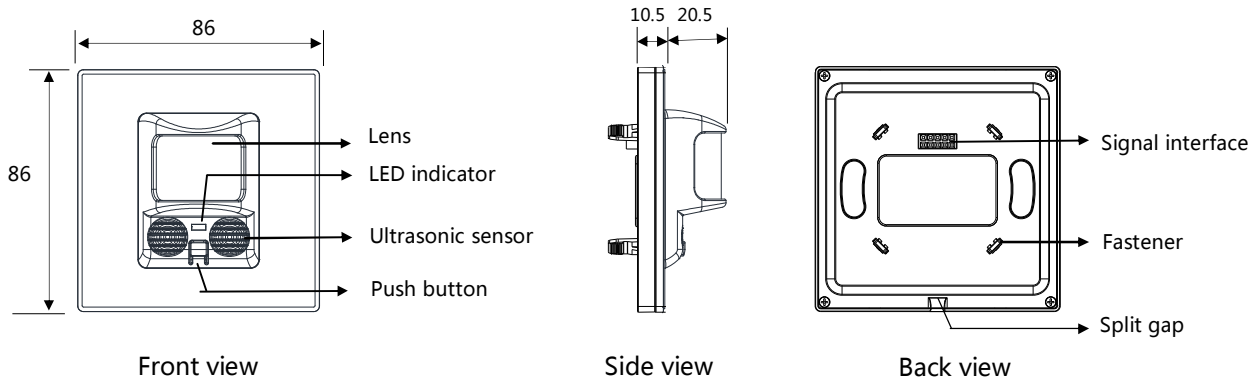

LED indicator: Red for PIR, Green for Ultrasonic, Orange for both PIR and Ultrasonic.

Push button: Trigger the logic condition.

Signal interface and fastener: Connect to power interface (MPPI.48).

Split gap: Insert a slotted screwdriver into the split gap, separate the sensor and power module (MPPI.48).

Installation

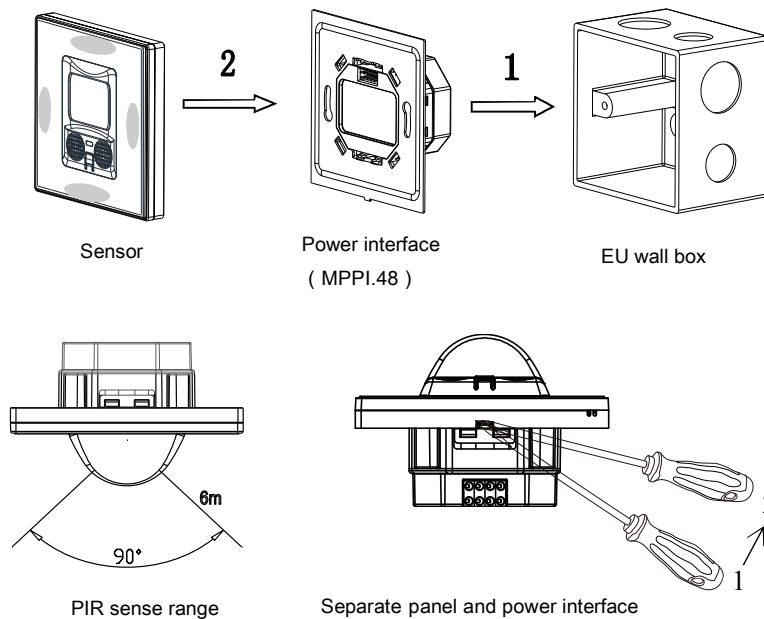

Installation: Hold the edge of sensor, (shown as above grey area,), then insert power interface module into the wall box vertically. Do not push the sensor too hard.

Split: Insert a screwdriver of 2.5mm into the split gap, pry up from position 1 to 2, and the wiring hole will open. Then separate the sensor and MPPI.48.

Safety Precautions



- The screw down strength should not exceed 0.2Nm.
- Do not make wrong connection on Buspro interface, it will damage the Buspro interface of this module.
- Do not let any liquid into the module, it will damage this device.
- Do not get AC power into Buspro wire, it will damage all devices in the system.

Packing List

- Datasheet ×1
- Ultrasonic & PIR Sensor (HDL - MSPU05.48) ×1

